



# HEATERS & VENTILATORS



## Compact heater

Prod. #: **805-1487**

Compact heater for installation along the wall or under a seat.  
Water connections for  $\frac{5}{8}$ " hose on the back.

Volts	Amp.	CFM	BTU	Dimensions
12	6,8	185	19 800	14" L x 5 $\frac{5}{16}$ " H x 8 $\frac{3}{16}$ " P

Replacement parts: **805-1409: Motor**

• Some parts may be lead time items. Consult our sales department for availability.



## Compact heater

Prod. #: **805-0155**

Supplied with cable and control valve. Water connections for  $\frac{5}{8}$ " hose on the back.

Volts	Amp.	CFM	BTU	Dimensions
12	5	174	20 382	10 $\frac{11}{16}$ " L x 8 $\frac{1}{4}$ " H x 7 $\frac{11}{16}$ " P

Replacement parts:  
**805-1409: Motor**



## Sturdy heater

Prod. #: **805-1416** Heater

Sturdy heater takes up little space, with connections for defroster.  
Water connections for  $\frac{5}{8}$ " hose on the back.

Volts	Amp.	CFM	BTU	Dimensions
12	4,50	173	22 089	8 $\frac{1}{16}$ " L x 8 $\frac{13}{16}$ " H x 8 $\frac{7}{16}$ " P

Replacement parts:  
**805-1409: Motor**



## Heater

Prod. #: **805-1568**

Heater for installation along the wall or under a seat. Supplied with two-speed switch.  
Water connections for  $\frac{5}{8}$ " hose on the bottom.

Volts	Amp.	CFM	BTU	Dimensions
12	6,8	236	22 400	11 $\frac{1}{4}$ " L x 8 $\frac{5}{8}$ " H x 6" P

Replacement parts:  
**805-1409: Motor**



## Compact heater

Prod. #: **805-1462**

Water connections for  $\frac{5}{8}$ " hose on the bottom.

Volts	Amp.	CFM	BTU	Dimensions
12	4,7	177	22 673	8 $\frac{1}{16}$ " L x 8 $\frac{7}{16}$ " H x 9" P

Replacement parts: 805-1409: Motor



## Heavy-duty heater

Prod. #: **805-1511**

Heavy-duty heater with two motors.  
Threaded holes for  $\frac{3}{4}$ " tubing on the sides or on the bottom.

Volts	Amp.	CFM	BTU	Dimensions
12	10	334	25 312	16" L x 7" H x 8" P

Replacement parts: 805-1198: Motor

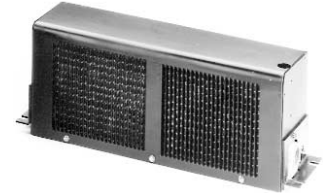

## Powerful area heater

Prod. #: **805-1695**

This heater can be installed out of the way with heat ducted to desired location.  
Four knock-outs allow installation flexibility.  
Water connections for  $\frac{5}{8}$ " hose on the back.  
Supplied with three-speed switch.  
Galvanized steel case.

Volts	Amp.	CFM	BTU	Dimensions
12	5,5	187	25 601	11 $\frac{3}{16}$ " L x 7 $\frac{7}{8}$ " H x 11 $\frac{7}{32}$ " P



## Powerful area heater

Prod. #: **805-1663**

A powerful area heater.  
Floor or wall mounted with multi-directional air flow.  
Water connections for  $\frac{5}{8}$ " hose on the back.

Volts	Amp.	CFM	BTU	Dimensions
12	5,7	341	36 547	10 $\frac{3}{4}$ " L x 9 $\frac{9}{32}$ " H x 11 $\frac{1}{2}$ " P



REV. 01/2011

## Heavy-duty heater with two motors

Prod. #: **805-1504** With  $\frac{3}{8}$ " NPT holes on the back

Prod. #: **805-1529** With  $\frac{3}{8}$ " NPT holes on the bottom

Volts	Amp.	CFM	BTU	Dimensions
12	11	349	39 375	15 $\frac{9}{16}$ " l x 7 $\frac{5}{8}$ " H x 11 $\frac{1}{2}$ " P

Replacement parts:  
**805-1409:** Motor



## Large capacity single fan heater

Prod. #: **805-1688**

A large capacity, single fan under seat or rear mount heater.  
Water connections for  $\frac{5}{8}$ " hose on the back.

Volts	Amp.	CFM	BTU	Dimensions
12	6,2	381	41 625	10 $\frac{47}{64}$ " l x 9 $\frac{9}{32}$ " H x 13 $\frac{3}{16}$ " P

Switch (off, high, low): **805-1039**, not included



## Large capacity single fan heater

Prod. #: **805-1335**

A large capacity, single fan under seat or rear mount heater.  
Water connections for  $\frac{5}{8}$ " hose on the back.

Volts	Amp.	CFM	BTU	Dimensions
12	6,4	426	48 801	10 $\frac{47}{64}$ " l x 9 $\frac{9}{32}$ " H x 17 $\frac{13}{64}$ " P

Switch (off, high, low): **805-1039**, not included



## Large capacity double fan heater

Prod. #: **805-1649**

A large capacity, double fan under seat or rear mount heater. Ideal for buses.  
Water connections for  $\frac{5}{8}$ " hose on the back.

Volts	Amp.	CFM	BTU	Dimensions
12	13,2	740	75 705	10 $\frac{47}{64}$ " l x 9 $\frac{9}{32}$ " H x 23 $\frac{13}{64}$ " P

Switch (off, high, low): **805-1039**, not included



**Replacement motors**

Prod. #	Voltage	A	B	C	D	E	Shaft	Rotation
805-1198	12V	1.200	3.34	2.550	2.94	2.312	1/4"	CCW
805-1409	12V	1.687	3.89	3.060	2.94	2.312	5/16"	CCW

4.5 amps.

• Some parts may be lead time items. Consult our sales department for availability.

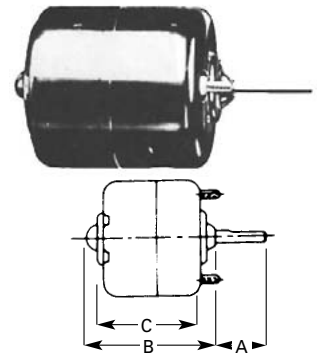
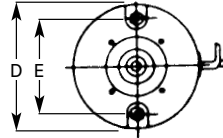

**Flexible hose**

Prod. #: **805-0349**

Accordion-type flexible hose for defroster.  
Diameter: 2"  
Length: 4'



• Some parts may be lead time items. Consult our sales department for availability.

**Nozzle**

Prod. #: **805-1374**

Metal defroster nozzle for 2" hose.  
7 1/2" overall length



**Hose clamps**

Stainless steel hose clamps with zinc plated screw system

Prod. #	Dimensions
805-0204	1/2" to 1"
805-0028	9/16" to 1 1/8"
805-0035	11/16" to 1 1/4"

50 per box



• Some parts may be lead time items. Consult our sales department for availability.

**Rubber hose for hot water**

In black single-ply rubber

Prod. #	Inside diameter	Roll
805-0451	5/8"	50'

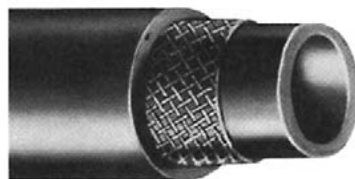

**Control valve**

Prod. #: **805-0236**

In black PVC  
5/8" tube X 5/8" tube



REV. 04/2013

## Flettner 2000 - Centrifugal air exhaust

Prod. #: **801-4407** Ventilator  
Prod. #: **801-4439** Collar

Expels old air from ambulances, vans, buses and boats.  
Also used at stationary sites such as mobile homes, on-site buildings, sheds, etc.

**Complete vent:**

Outside diameter: 8.9"  
Inside diameter: 7.4"  
Mounting hole: 3.9"

**Air exhaust information:**

Km/h	Cubic feet/minute
16	8
32	19
48	30
64	41
80	52
96	63
112	75

Collar for connecting external and internal parts in thick roofs.

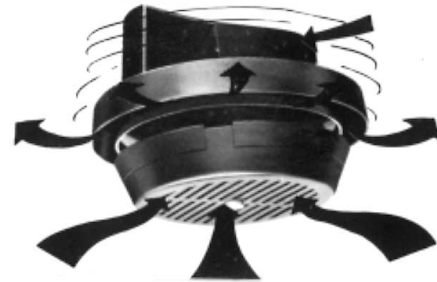

## Flettner TCX-2 - Centrifugal air exhaust

Prod. #: **801-5520** Black (Collar included)  
Prod. #: **801-5620** White (Collar included)  
Prod. #: **801-5545** Black (Ventilator only)  
Prod. #: **801-5610** White (Ventilator only)  
Prod. #: **801-5577** Collar

Expels old air from ambulances, vans, buses and boats.  
Also used at stationary sites such as mobile homes, on-site buildings, sheds, etc.  
The ball bearings are incredibly smooth running and are made of high quality stainless steel.

**Complete vent:**

Outside diameter: 10.2"  
Inside diameter: 7.8"  
Mounting hole: 3.9"

**Air exhaust information:**

Km/h	Cubic feet/minute
16	18
32	37
48	58
64	81
80	102
96	126
112	149



Adjustable shutter

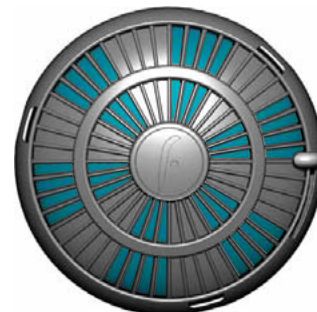

REV. 01/2011

**Ventilators**

By virtue of their form, these vents cause air to be drawn out when the vehicle is in motion.

Steel with primer coating.  
Supplied with gasket  
Dim.: 2" W x 10" L x 12" D

Grill fits mounting holes on above vent.  
**Must be ordered separately.**  
Zinc plated  
Diameter: 7 1/4"

Prod. #: **801-1036** Ventilator, without grill  
Prod. #: **801-1029** Adjustable interior grill



**Static exhaust vent**

Prod. #: **801-1131**

Expels air at a rate of 30 cu. ft./min. at 48 Km/h.  
Interior grill not included.  
See below.  
Dim.: 3 11/16" W x 9" L x 15" D



**Static intake vent**

Prod. #: **801-1117**

Draws outside air inside  
Interior grill not included.  
See below.  
Dim.: 2 5/8" W x 9" L x 15" D



**Exhaust power ventilation**

Prod. #: **801-1170**

Expels air toward the outside.  
Flow rate of 200 cu. ft./min. in the stationary position.  
Install with grill facing toward the back of the vehicle.  
Dim.: 6 1/4" W x 11" L x 15" D  
Supplied with inside grill **801-1124**, and switch.  
**Replacement part 805-1409:** 12 volt motor



**Exhaust power ventilation**

Prod. #: **801-1149**

Expels air toward the outside.  
Flow rate of 100 cu. ft./min. in stationary position.  
Interior grill is not included.  
See below.  
Dim.: 3 11/16" W x 9" L x 15" D  
**Replacement part 805-1198:** 12 volt motor



**Power intake vent**

Prod. #: **801-1156**

Draws outside air inside.  
Interior grill is not included.  
See opposite.  
Dim.: 2 5/8" W x 9" L x 15" D  
**Replacement part 805-1198:** 12 volt motor



**Inside grills**

Prod. #	Diameter	Finish	
A - 801-1188	8"	Black primer	Adjustable
B - 801-1124	8"	Black primer	Screen only



• Some parts may be lead time items. Consult our sales department for availability.

REV. 04/2013

## Adjustable louver

Prod. #: **801-1068**

Aluminum

Height: 10 1/2"  
Length: 12 1/4"



## Non-adjustable louver

Prod. #: **801-1050**

Non-adjustable louver  
(always open).  
Aluminum

Height: 10 1/2"  
Length: 12 1/4"

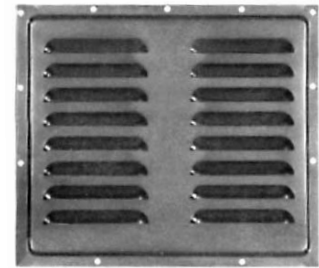

## Stainless steel louver

Prod. #: **801-5707**

Non-adjustable louver (always open).  
Stainless steel

Height: 9"  
Length: 5"



## Non-adjustable louver

Prod. #: **801-0346**

Non-adjustable louver (always open).  
Plastic

Colour: Black  
Height: 4 7/8"  
Length: 10 1/8"

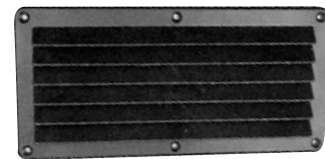

## Non-adjustable louver

Prod. #: **801-0360**

Non-adjustable louver (always open).  
Plastic

Colour: Black  
Height: 3 7/8"  
Length: 7 7/8"

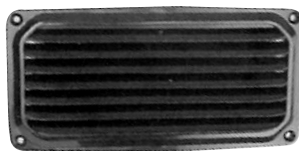

## Round vent

Prod. #: **801-4414**

Round vent in aluminum casting  
for ventilating trailers.  
Opens to 3 settings using  
outside lever.

Round vent: 5 1/2"  
Diameter: 9 1/2"



## Stainless steel round vents

Prod. #: **801-0265** \*  
Prod. #: **801-0272**

4" dia.  
5" dia.

Stainless steel (304)

\* Minimum of 10



## Stainless steel butterfly vent

Prod. #: **801-0307**

Stainless steel (304) round  
butterfly-style vent  
with knob on blade.

Diameter: 5"





### Electric fan

Prod. #: **803-3008**

Flow rate of 250 cu. ft./min.  
6 1/2" dia. blades in chrome grill.  
Toggle switch with 3 settings located on the adjustable base.

Motor	Dimensions
12-volt -2 speed	9 1/2" H x 4 3/4" D x 7 7/8" L



### Electric fan

Prod. #: **803-3174**

Toggle switch with 3 settings  
Adjustable base  
Black base, motor and grill with plastic blades and grill.  
200 cu. ft./min.

Motor	Dimensions
12-volt -2 speeds	8 3/4" H x 5 1/8" D x 7 1/2" L



## Air inlets

- Prod. #: **801-0434** Black-enameled steel without trimring and gasket  
 Prod. #: **801-0064** Black-enameled steel with trimring and gasket

Raised models for mounting on roof.

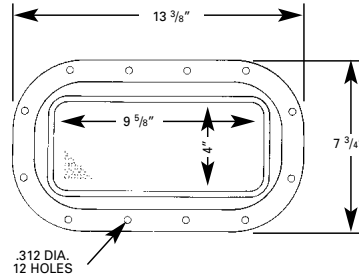

## Air inlet

Prod. #: **801-0145**

Untreated aluminum with trimring and gasket  
 Raised models for mounting on roof.

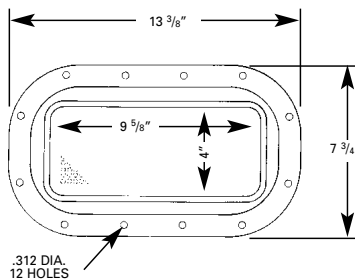

## Trimring

Prod. #: **801-0177**

Black, plastic trim 2" thick  
 Easily cut to required thickness for 801-0434.



## Air inlets

Air inlets providing inflow or outflow of air depending on the position of the cover, which opens in both directions.  
 Solid, watertight construction with screen.  
 Flat models for vertical installation on the sidewalls of vehicles. With tubular handle.

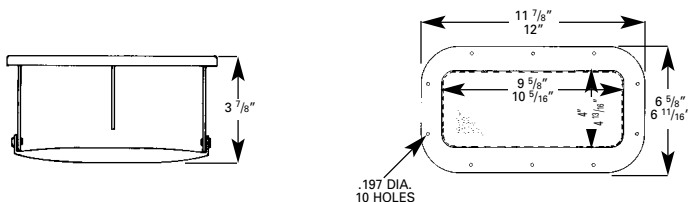

### Dimensions

Prod. #		Cover	Overall
801-0089	Black, enameled steel (with gasket)	10 5/16" X 4 13/16"	11 7/8" X 6 5/8"
801-0025	Untreated aluminum (without gasket)	9 5/8" X 4"	12" X 6 11/16"